

AUTOMATIC BOOSTER PUMP



- **CONSTANT WATER SUPPLY**
- **SUITABLE FOR HOT WATER**
- **LOW NOISE**

24 months
≡ **WARRANTY** ≡



Pressure Tank

maintenance free,
3.7mm thickness EPDM
membrane



Pressure Switch

Automatically on the pump according
to the discharge pressure and the
setting pressure

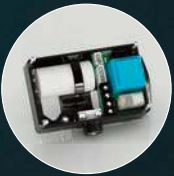

Electronic Control Panel

Monitor and regulate the working
conditions of pump



Flow Sensor

Monitor the water flow of pump,
help the pump working perfectly
at a small water flow condition,
dry-run protection

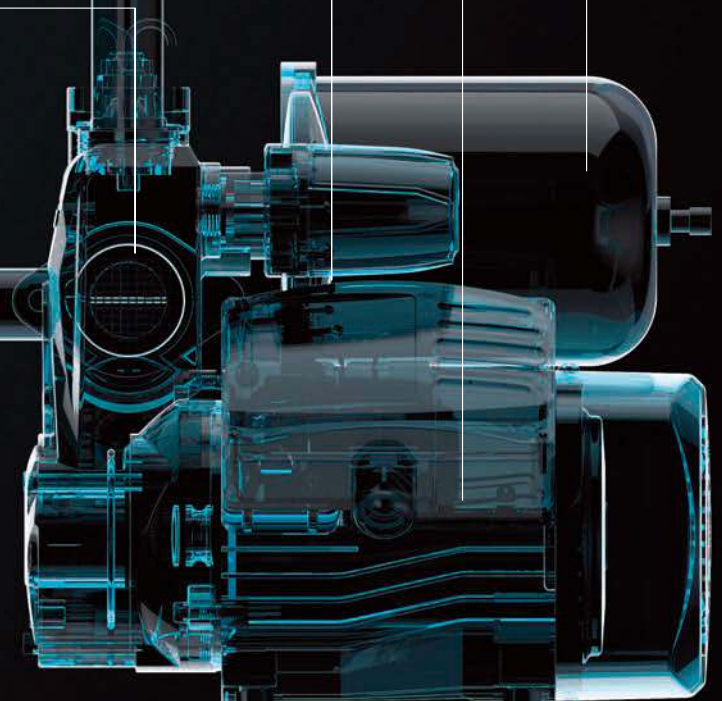

MAIN PARTS DISPLAY

INNOVATION



Fully automatic. when you turn on the tap or shower, the pump will be power on. when you turn off, the pump will be power off accordingly.



The microcomputer control system ensures that the pump can be used normally at a small flow rate, realizing the full lift operation of the pump and constant water supply.



Dry-running protection, the pump will be automatically power off after 6 minutes, while there is no water detected in the pipeline.

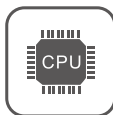

Anti-block protection, 8 seconds automatic running for every 72 hours



Suitable for hot water up to 100°C



In order to protect the user's personal safety, the pump will be delayed start for 3 seconds after power-on.



Operating in significantly low noise $65\text{dB} \leq$, much quieter than most other self-priming pumps currently available in the market.



160-260V/50HZ wide operation voltage

AUTOMATIC BOOSTER PUMP



APPLICATION

AQUA series is a new generation automatic booster pump can supply constant water. The integrated pump includes motor, tank, pressure switch, flow sensor in one unit that is more reliable and easy to operate. It's suitable for both cold and hot water, can be widely used in household pressure boosting from above ground water tanks or below water sources.

House Building Pressure Boosting

pressure boosting for entire house building with one tap of each floor, flow of each tap is $0.7\text{m}^3/\text{h}$ - $0.9\text{m}^3/\text{h}$, the pressure lose of each elbow is 1 meter, with a suction lift of up to 8 meters and ideal suction within 6 meters. one more tap for each floor can be applied if the one floor is less than recommended floor numbers of each AQUA series model.

Apartment Pressure Boosting

pressure boosting for apartment with 2-3 taps, flow of each tap is $0.7\text{m}^3/\text{h}$ - $0.9\text{m}^3/\text{h}$, the pressure lose of each elbow is 1 meter.

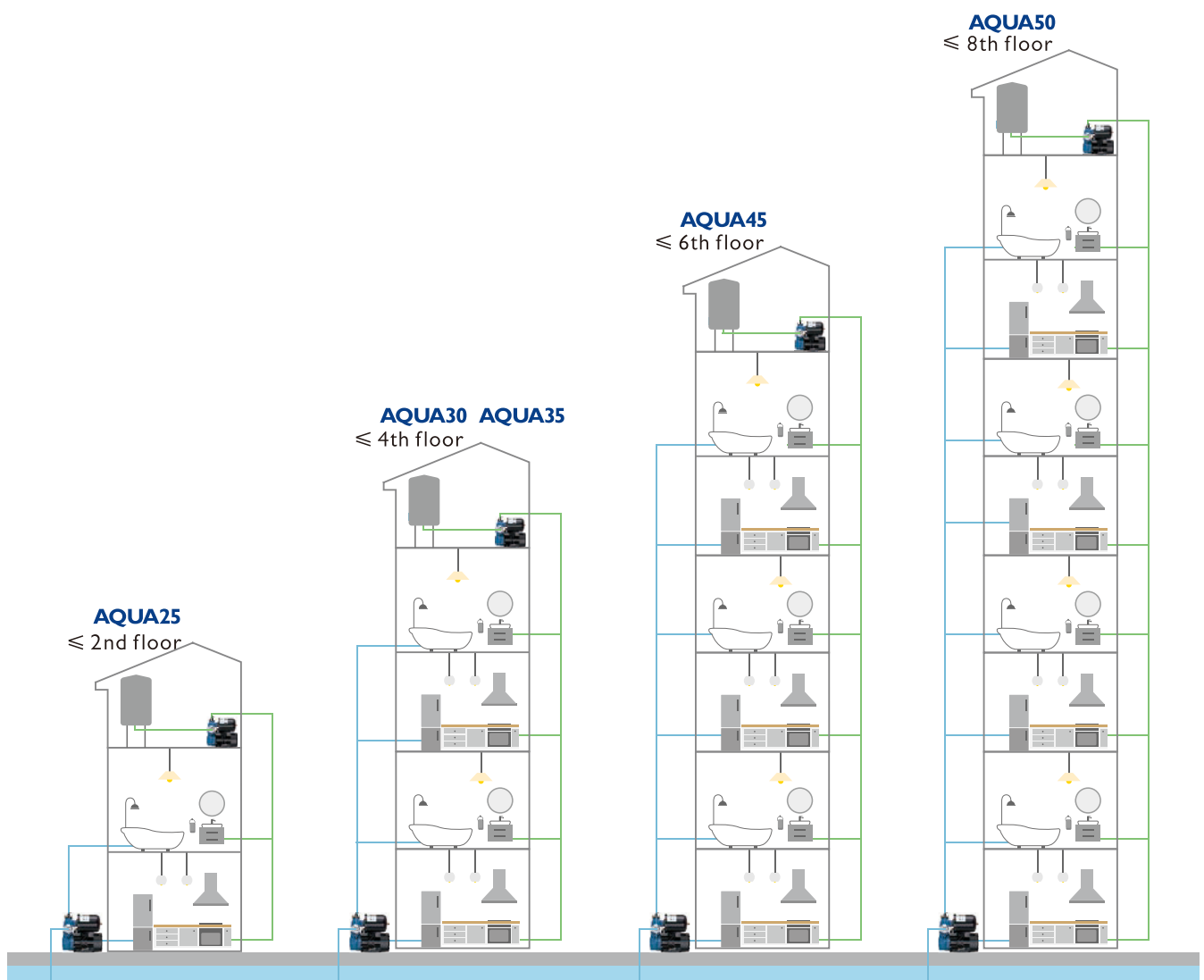

INSTALLATION DIMENSIONS

AQUA25

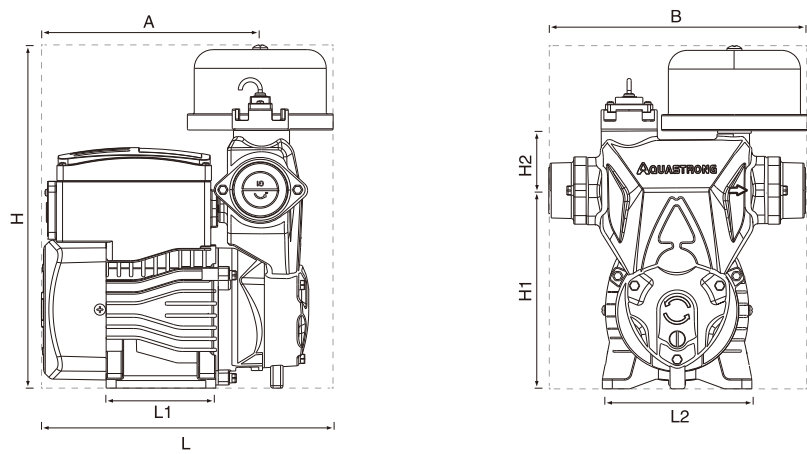

AQUA30 / AQUA35 / AQUA45 / AQUA50

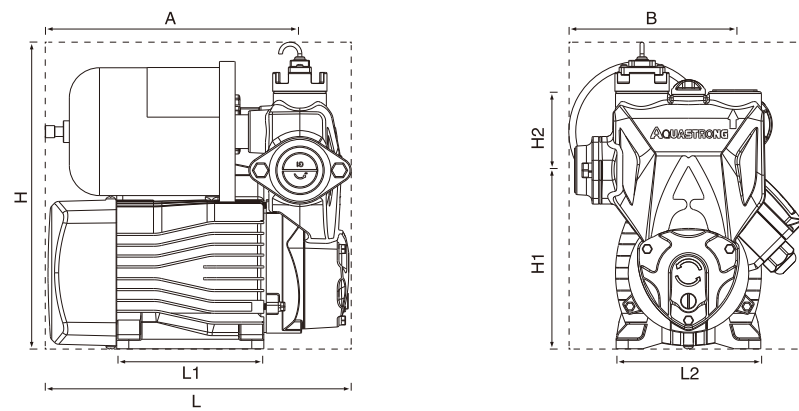

Model	A	B	L	L1	L2	H	H1	H2
AQUA25	17cm	17cm	22cm	10cm	10cm	29cm	15cm	14cm
AQUA30	22cm	15cm	25cm	10cm	10cm	25cm	15cm	10cm
AQUA35	22cm	15cm	25cm	10cm	10cm	25cm	15cm	10cm
AQUA45	23cm	16cm	27cm	10cm	11.5cm	27cm	17cm	10cm
AQUA50	24cm	18cm	28cm	10cm	11.5cm	28cm	22cm	11cm

Operation CONDITIONS

- Liquid temperature: 0°C~+100°C
 - PH: 6.5-8.5
 - Solid particles $\leq 0.2\text{mm}$; solid impurity volume ratio $\leq 0.1\%$
- Voltage: 160-260V/50HZ
 - Protection class: IPX4
 - Ambient temperature:Max.+55°C

PERFORMANCE PARAMETER TABLE

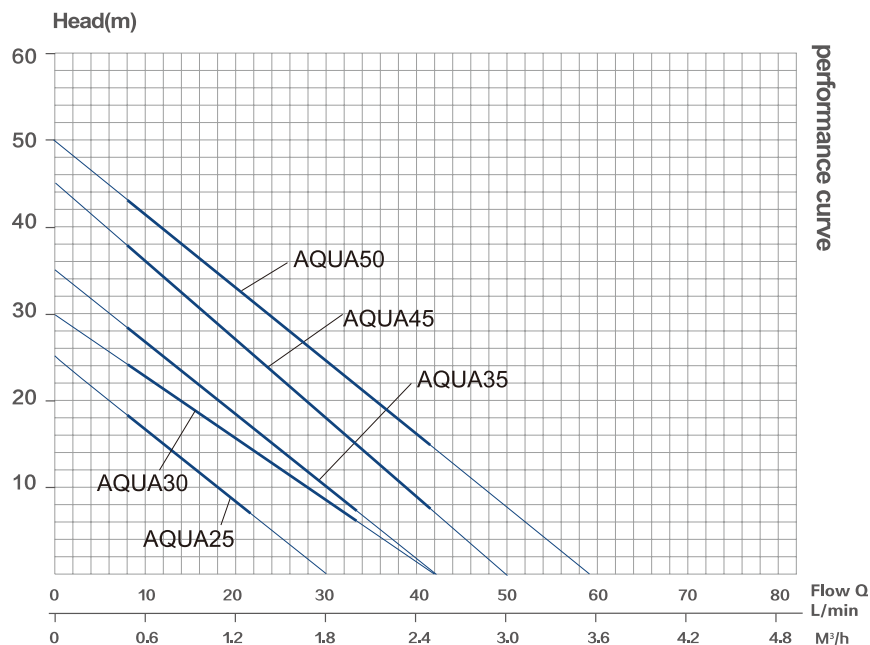

Model	Power (w)	Q L/min m³/h	H(m)												
			0	5	10	15	20	25	30	35	40	45	50	55	60
AQUA25	250	H(m)	0	0.3	0.6	0.9	1.2	1.5	1.8	2.1	2.4	2.7	3	3.3	3.6
AQUA30	370		25	21	16	11	7	3	0	-	-	-	-	-	-
AQUA35	450		30	26	23	19	15	11	8	5	1	0	-	-	-
AQUA45	750		35	31	26	22	18	13	9	4	2	0	-	-	-
AQUA50	850		45	40	35	31	27	22	18	15	9	4	0	-	-
			50	45	41	37	33	29	24	20	16	11	7	3	0

Model	Max.Head m	Max.Flow		Rated.Head m	Rated.Flow		Piping size mm	Suction m
		m³/h	l/min		m³/h	l/min		
AQUA25	25	1.8	30	12	1	17	25	8
AQUA30	30	2.5	42	13.5	1.3	22	25	8
AQUA35	35	2.5	42	15	1.5	25	25	8
AQUA45	45	3	50	22	1.5	25	25	8
AQUA50	50	3.5	58	28	1.5	25	25	8

Model	Voltage	Power(W)	Current(A)	Start Pressure (Bar)	Max.floor
AQUA25	160-260V/50Hz	250	1.5	1.8	≤2nd follr
AQUA30	160-260V/50Hz	370	2.5	1.8	≤4th follr
AQUA35	160-260V/50Hz	450	2.7	2.1	≤4th follr
AQUA45	160-260V/50Hz	750	4.2	2.6	≤6th follr
AQUA50	160-260V/50Hz	850	5.2	3.1	≤8th follr



**CONSTANT WATER SUPPLY
SUITABLE FOR HOT WATER
LOW NOISE**

AQUASTRONG S.r.l

Add: Via Bramante 3520154 Milano Italy

Tel: +39 0294 7591 77

Fax: +39 0294 7591 77

www.aquastrong.it

E-mail: info@aquastrong.it